



Viewing by appointment only
Allen Goldstein - Bloomsbury
104 Cromer Street , London WC1H 8BZ
Tel: 020 7183 4101 Email: enquiries@allengoldstein.com Website: <http://www.allengoldstein.com>



St Pancras Way, NW1

Well Maintained 3 bed Property in
Camden Town, NW1

£660,000 Leasehold

Description

Allen Goldstein is proud to present this three double bedroom property on the second floor (with lift access) of a secure building in the ever popular Camden Town.

The spacious property comprises of a large lounge with access to a private balcony.

An eat in kitchen that easily accommodates a dining table and four chairs. It comes with all modern appliances (there is a possibility of keeping them) adding extra convenience.

The double bedrooms all come with built in wardrobes which helps maximise space.

There is a fully tiled bathroom with a bathtub and shower and a separate WC.



Viewing by appointment only
Allen Goldstein - Bloomsbury
104 Cromer Street , London WC1H 8BZ
Tel: 020 7183 4101 Email: enquiries@allengoldstein.com Website: <http://www.allengoldstein.com>



ALLEN GOLDSTEIN

Bernard Shaw Court

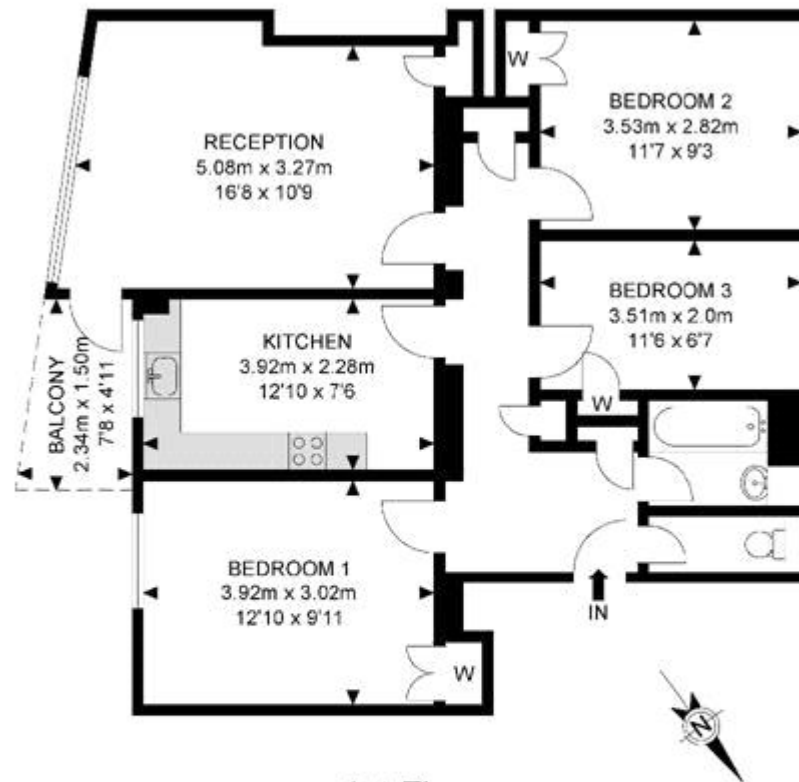

1st Floor

APPROX. GROSS INTERNAL FLOOR AREA 813.75 SQ FT / 75.60 SQM

Whilst every attempt has been made to ensure the accuracy of the floor plan contained here, measurements of doors, windows, rooms and any other items are approximate and no responsibility is taken for any error, omission or mis-statement. This plan is for illustrative purposes only and should be used as such by any prospective purchaser. The service, system and appliances shown have not been tested and no guarantee as to their operability or efficiency can be given.

© SpacePhoto

Photography and Floor Plan

ALLEN GOLDSTEIN

Viewing by appointment only
Allen Goldstein - Bloomsbury
104 Cromer Street , London WC1H 8BZ
Tel: 020 7183 4101 Email: enquiries@allengoldstein.com Website: <http://www.allengoldstein.com>



ALLEN GOLDSTEIN





Energy Efficiency Rating		
	Current	Potential
<i>Very energy efficient - lower running costs</i>		
(92-100) A		
(81-91) B		
(69-80) C	75	
(55-68) D		
(39-54) E		
(21-38) F		
(1-20) G		

Viewing by appointment only
 Allen Goldstein - Bloomsbury
 104 Cromer Street , London WC1H 8BZ
 Tel: 020 7183 4101 Email: enquiries@allengoldstein.com Website: <http://www.allengoldstein.com>

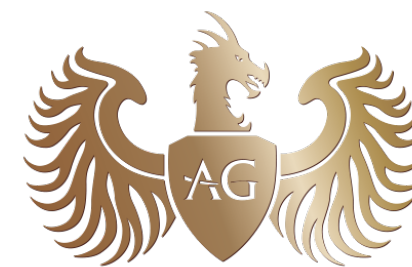

ALLEN GOLDSTEIN